

- LEGEND**
- L ARC LENGTH
  - AE ACCESS EASEMENT
  - BE BUFFER EASEMENT
  - Δ CENTRAL (DELTA) ANGLE
  - CCB CIRCUIT COURT BOOK
  - CH CHORD
  - (C) CALCULATED
  - (D) DEED
  - DB DEED BOOK
  - DE DRAINAGE EASEMENT
  - ESMT EASEMENT
  - FEE FLORIDA POWER AND LIGHT
  - IEE INGRESS/EGRESS EASEMENT
  - LAE LIMITED ACCESS EASEMENT
  - LME LAKE MAINTENANCE EASEMENT
  - LMAE LAKE MAINTENANCE ACCESS EASEMENT
  - LSE LIFT STATION EASEMENT
  - (NR) NON-RADIAL
  - NO. NUMBER
  - PCD PLANNED COMMUNITY DEVELOPMENT
  - ORB OFFICIAL RECORD BOOK
  - PB PLAT BOOK
  - PG(S) PAGE(S)
  - R RADIUS
  - RPB ROAD PLAT BOOK
  - SLE SEWER LINE EASEMENT
  - SUA SEACAST UTILITY AUTHORITY
  - (TYP) TYPICAL
  - UE UTILITY EASEMENT
  - WLE WATER LINE EASEMENT
  - WSE WATER AND SEWER EASEMENT
  - PERMANENT REFERENCE MONUMENT
  - SET LB-04B
  - PERMANENT CONTROL POINT
  - SET LB-04B
  - ⊖ CENTERLINE

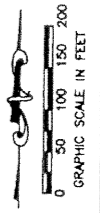

21

STATE OF FLORIDA  
COUNTY OF PALM BEACH

THIS PLAT WAS FILED FOR  
RECORD  
THIS \_\_\_\_\_ DAY OF \_\_\_\_\_  
AD, 2000 AND DULY RECORDED  
IN PLAT BOOK \_\_\_\_\_ OR PAGES  
\_\_\_\_\_ AND \_\_\_\_\_

DOROTHY H. WILKEN, CLERK  
BY: \_\_\_\_\_, D.C.

CIRCUIT COURT SEAL

# MIRASOL PLAT ONE

PART OF GOLF DIGEST P.C.D.  
SITUATE IN SECTIONS 33 AND 34, TOWNSHIP 41 SOUTH, RANGE 42 EAST,  
AND SECTIONS 3 AND 4, TOWNSHIP 42 SOUTH, RANGE 42 EAST,  
CITY OF PALM BEACH GARDENS,  
PALM BEACH COUNTY, FLORIDA  
MARCH, 2000 SHEET 8 OF 10

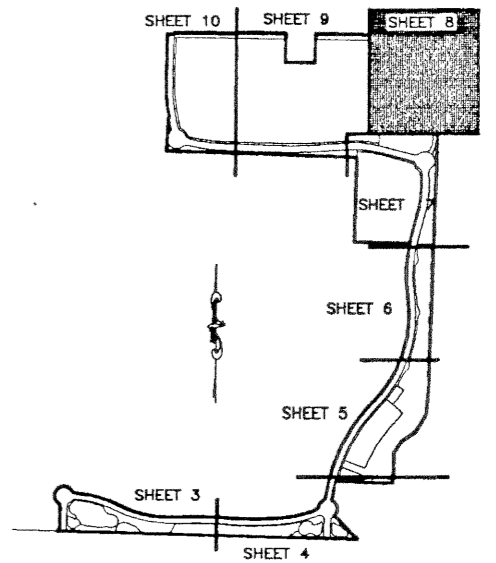

SHEET LOCATION MAP  
NOT TO SCALE

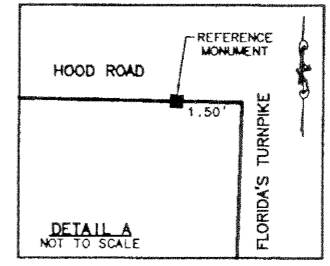

DETAIL A  
NOT TO SCALE

THIS INSTRUMENT WAS PREPARED BY MARY HANNA CLODFELTER, P.S.M. IN THE OFFICES OF MOCK, ROOS & ASSOCIATES, INC., 5720 CORPORATE WAY, WEST PALM BEACH, FLORIDA 33407.

SCALE:  
1" = 100'  
P.A. NO.:  
99310.00  
DATE:  
MARCH, 2000  
DRAWING NO.:  
41-42-33-18

FLORIDA L.B. NO. 48

**MOCK ROOS**  
ENGINEERS AND SURVEYORS

5720 Corporate Way, West Palm Beach, Florida 33407  
(561) 683-3113, Fax 478-7248

MIRASOL PLAT ONE  
PART OF GOLF DIGEST P.C.D.  
SITUATE IN SECTIONS 33 AND 34,  
TOWNSHIP 41 SOUTH, RANGE 42 EAST,  
AND SECTIONS 3 AND 4,  
TOWNSHIP 42 SOUTH, RANGE 42 EAST,  
CITY OF PALM BEACH GARDENS,  
PALM BEACH COUNTY, FLORIDA

SHEET 8 OF 10

S:\Work\Projects\07\07\_03\07\_03\_01.dwg 10/20/00 11:25:38 AM EDT

REV.: 09-11-00  
CAD FILE:  
TAYLOR\GOLF\PRP07

MATCH LINE - SEE SHEET 7